



21 Pauldon Drive Sandy Bay TAS

3  2  2 

This stylish architect-designed home occupies a commanding cul-de-sac position within a relatively quiet no through Sandy Bay street. This homes offer 180 degrees of absolute panorama, boasting expansive Derwent estuary views, capturing a close up diverse outlook from Bellerive oval in the north to Betsy island and beyond to the South, with a host of suburban, country, beach and ocean views within those parameters.

The home itself offers generous living areas, including a European appliance kitchen. Each area offering access to a fully enclosed atrium room. All living areas benefit from the full panorama on offer, with the later perfectly placed for ringside enjoyment of the ever-changing scenery, including passing dolphins, whales and all manner of sea craft.

There are 2 spacious bedrooms at entry level with a stylish

Price : \$ 925,000
Building Size : 178 sqm
Land Size : 838 sqm
View : <https://www.lennardmclure.com.au/sale/tas/hobart-southern/sandy-bay/residential/house/5923920>



John Lennard
6169 2555



Johnnie Lennard
6169 2555

21 Pauldon Dr, Sandy Bay TAS 7005
Approx Internal Space 178 sqm

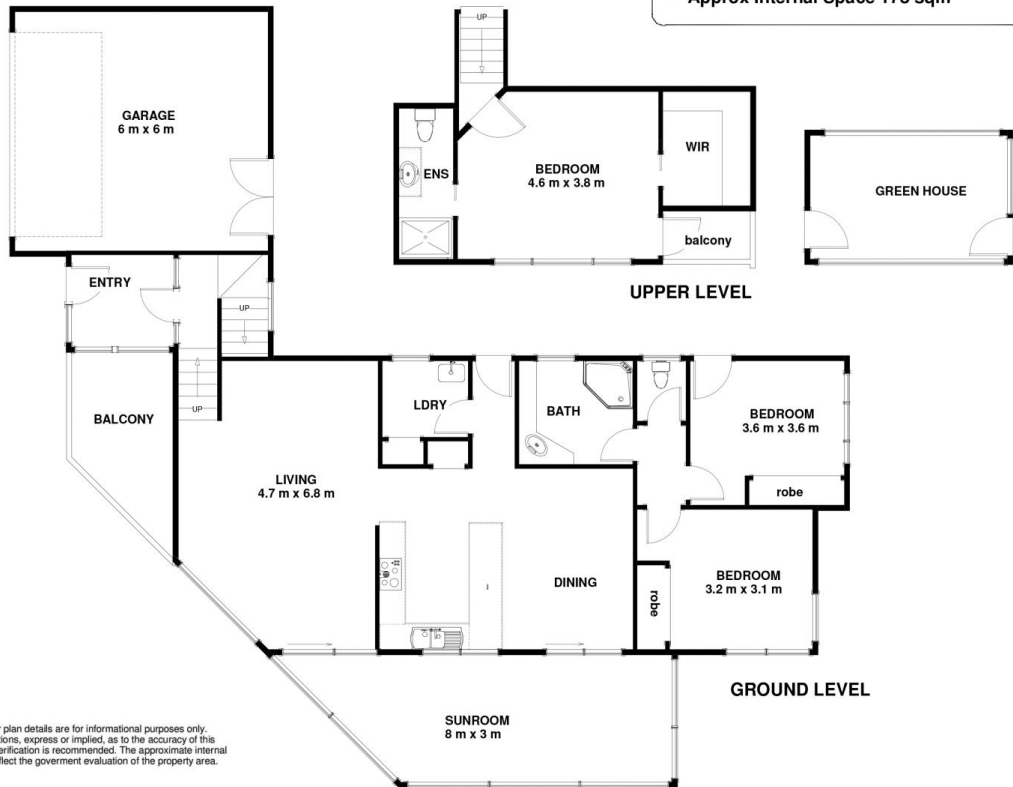

Disclaimer: All measurements and floor plan details are for informational purposes only. We make no warranties or representations, express or implied, as to the accuracy of this rendering. Independent property size verification is recommended. The approximate internal area measurement does not directly reflect the government evaluation of the property area.