



2/31 Poets Road West Hobart TAS

2  1  1 

One of only two, this spacious apartment enjoys superb Derwent estuary, Wrest Point Casino, Hobart City and Eastern shore panoramic views.

Boasting a fantastic floorplan, two good-sized bedrooms both with built-in robes and phenomenal views from the main bedroom. With the open-plan living and kitchen space already established, this home would benefit from straightforward upgrades throughout.

This property is located in a quiet no-through street in the highly sought city fringe suburb of West Hobart within walking distance of the CBD close to a host of shops, services and transport

Price : \$ 475,000
Building Size : 87 sqm
Land Size : 103 sqm
View : <https://www.lennardmclure.com.au/sale/tas/hobart-southern/west-hobart/residential/apartment/6340020>



Johnnie Lennard
6169 2555



John Lennard
6169 2555

Unit 2/31 Poets Road

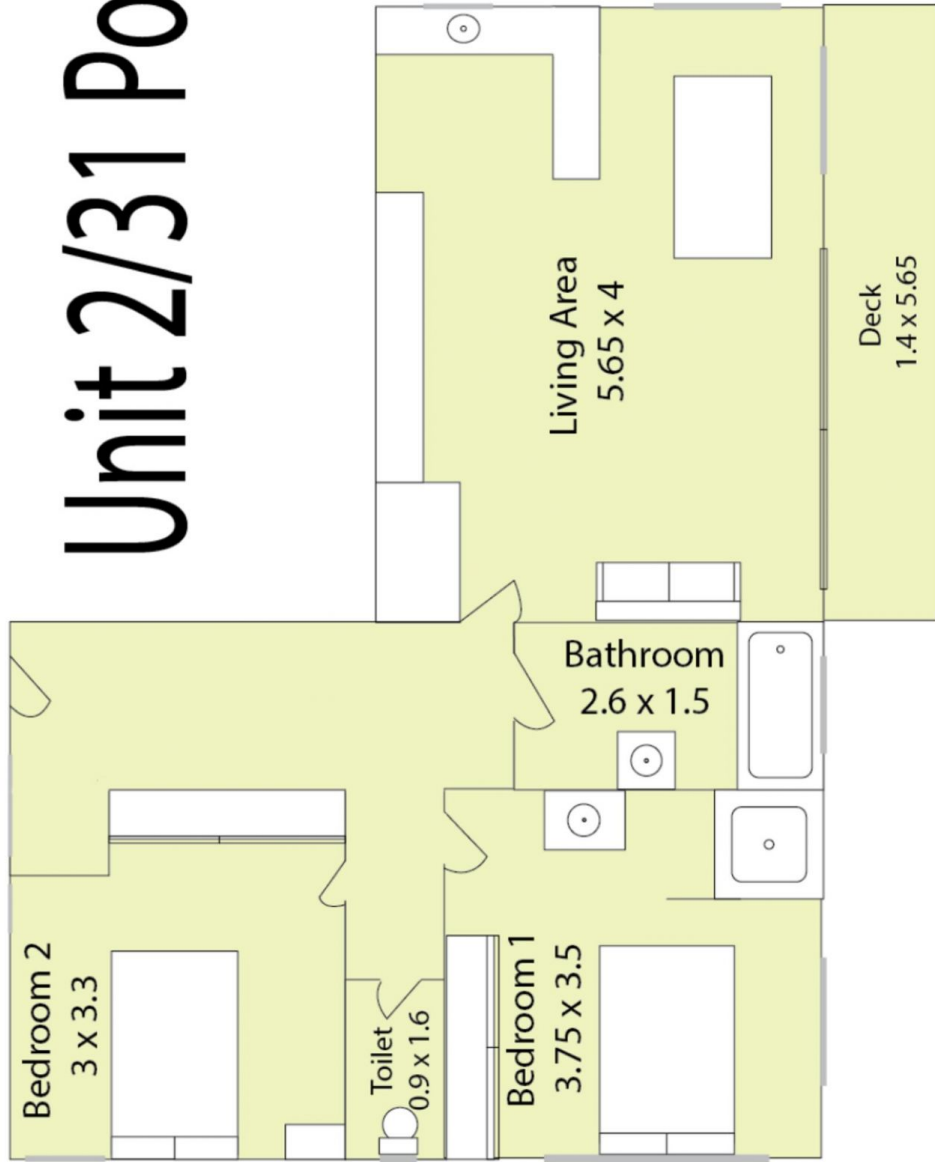

Disclaimer: Whilst ever attempt has been made to ensure the accuracy of the floor plan contained here, measure meets are approximate & no responsibility is taken for an error, omission or mis-statement. This floor plan is for illustrative purposes only & should be used as such by any prospective purchaser. All fixtures & fittings are for display purposes only. Dimensions are in meters.