



47 Midway Point Esplanade Midway Point TAS

4 🛏 2 🚿 4 🚗

This ultra-stylish four bedroom, two bathroom executive family home is not only a standout property within its exclusive Esplanade location but also within its entire suburb.

Designed to take full advantage of the northerly aspect, there are solar panels on the roof and bi-fold doors connecting expansive architecturally striking indoor living areas to the amazing outdoors, via a spectacular and spacious well-constructed entertainment deck. All living areas and master bedroom benefit from seriously picturesque, serene, close-up water and woodland views. This home is just a stone's throw from the waters edge.

All bedrooms are spacious with two on each level. All are complimented with built-in wardrobes, the master boasting an impressive and generously proportioned ensuite bathroom. There is a second bathroom located downstairs,

Price : \$ 950,000
Building Size : 251 sqm
Land Size : 650 sqm
View : <https://www.lennardmclure.com.au/sale/tas/hobart-southern/midway-point/residential/house/6705412>



John Lennard
6169 2555



Johnnie Lennard
6169 2555

47 Esplanade Midway Point Tas 7171
Approx Internal Space 210 sqm

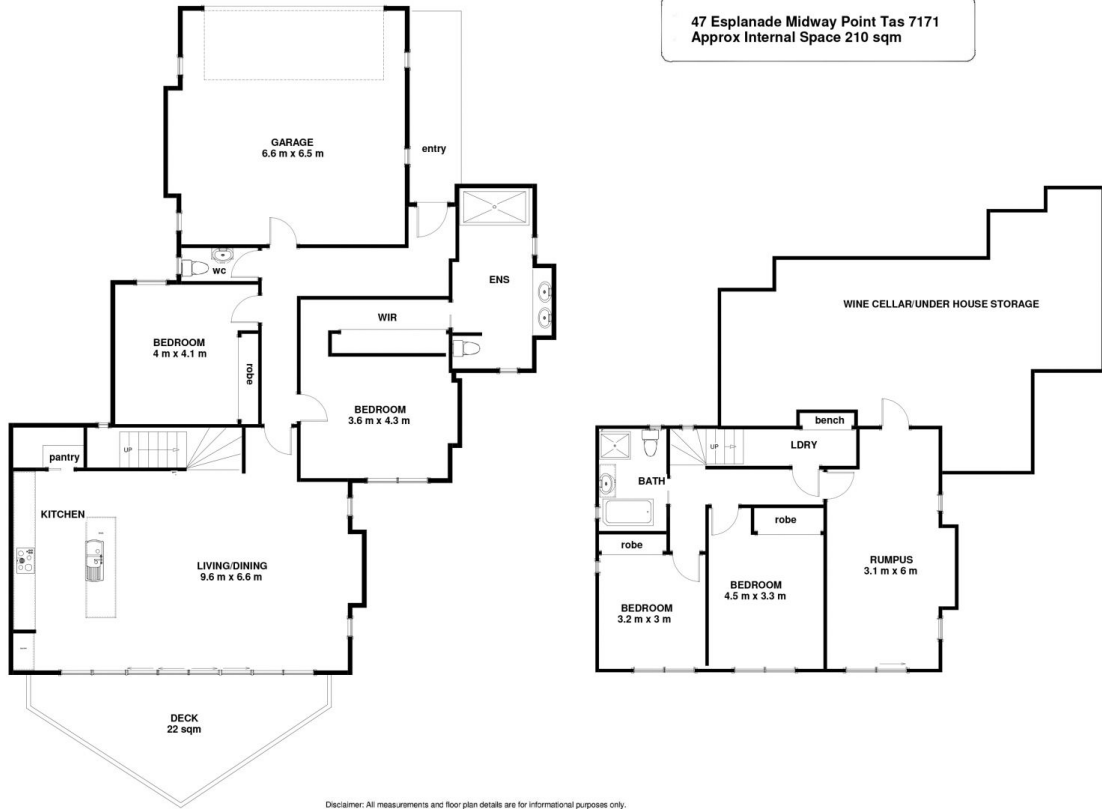

Disclaimer: All measurements and floor plan details are for informational purposes only. We make no warranties or representations, express or implied, as to the accuracy of this rendering. Independent property size verification is recommended. The approximate internal area measurement does not directly reflect the government evaluation of the property area.