





3 Myella Drive Berriedale TAS

3  1  4 

This property would seem ideal for first home buyers seeking an affordable, beautifully presented home.

The kitchen is new with quality appliances. The bathroom also benefits from a recent stylish renovation. The floorplan itself is super practical.

A near level generous land parcel boasts loads of off-street parking with a modern recently installed shed and so much potential for further development, either as garden and or outdoor entertainment area.

The ultra-convenient Berridale location is so easily accessed via the Brooker Highway, the waterfront, Mona Museum, Moorilla Vineyard and several council-maintained recreation areas are all within an easy walking distance. The business hub of the city of Glenorchy is within a short drive away, a host of schools are close by and local pizza is around a one minute walk from the front door.

Price : \$ 486,000
Building Size : 95 sqm
Land Size : 625 sqm
View : <https://www.lennardmclure.com.au/sale/tas/hobart-southern/berriedale/residential/house/7347602>



John Lennard
6169 2555



Johnnie Lennard
6169 2555

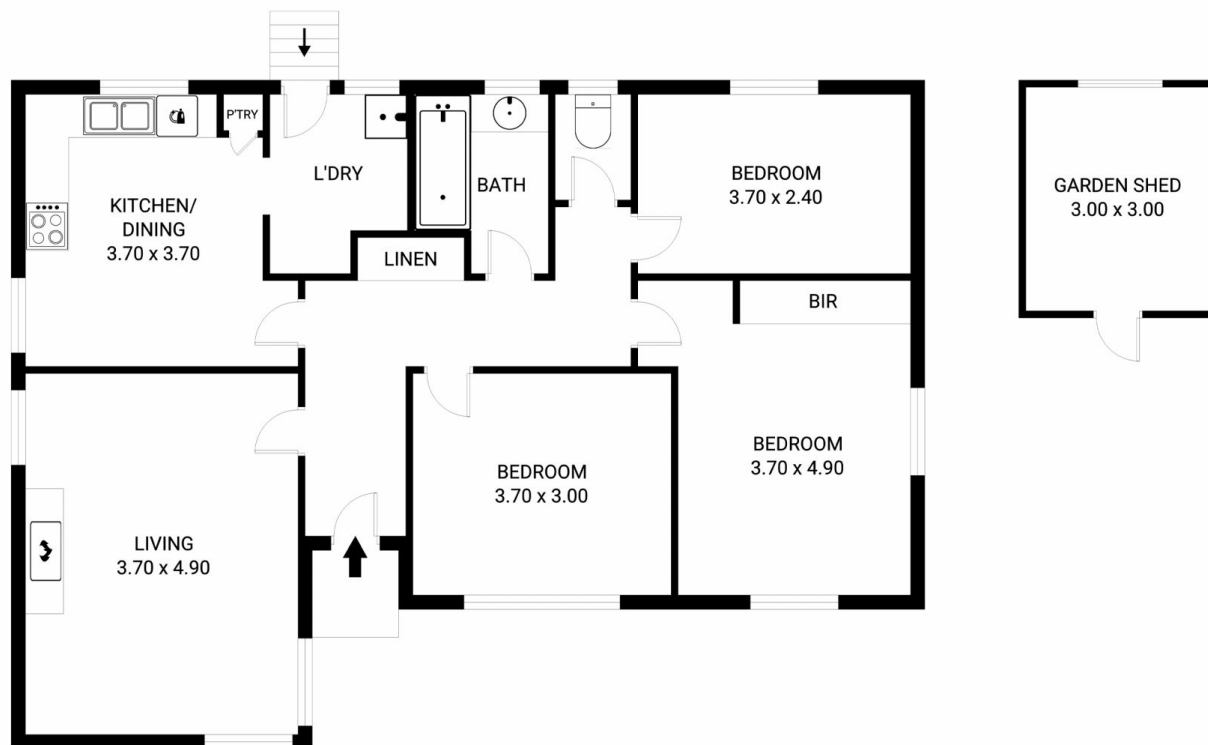

3 Myella Drive, Berriedale
Total approx. floor area: 95m²

Areas and dimensions are approximate and therefore
this floor plan should only be used for illustrative purposes.
Real Estate Marketing by nextcreative.com.au

