



**1/29 Red Chapel Avenue Sandy Bay TAS**

3  2  4 

This property occupies a commanding position within a well-structured group of quality villas, so well situated within one of Sandy Bays most prestigious and highly sought streets.

The sheer size of this home is exceptional with two generous living areas, plus such a beautiful, recently upgraded and expansive eat in kitchen, all benefiting from wide ranging Derwent Estuary vista.

All three bedrooms are exceptionally spacious and well located, with the master benefitting from an ensuite bathroom. On this level the fabulous Juliette balcony captures the best and most diverse vista of all, including views over Battery Point, Hobart City, Marina and Derwent Estuary.

**Building Size** : 185 sqm  
**Land Size** : 450 sqm  
**View** : <https://www.lennardmclure.com.au/sale/tas/hobart-southern/sandy-bay/residential/house/7762739>



**John Lennard**  
6169 2555



**Johnnie Lennard**  
6169 2555

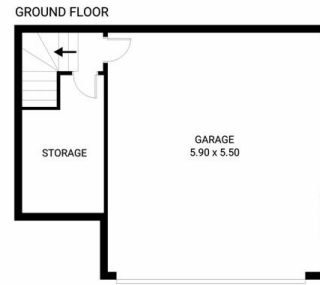

1/29 Red Chapel Avenue, Sandy Bay  
 Total approx. floor area: 203m<sup>2</sup>

Areas and dimensions are approximate and therefore  
 this floor plan should only be used for illustrative purposes.

Real Estate Marketing by [nextcreative.com.au](http://nextcreative.com.au)

